



**The**  
**Austrian**  
**Collection**  
**2021**

(Effective 10/01/2020)

by

**Iron Lock Imports**

960 E 300 N  
Springville UT 84663  
877-650-5101



Item	Description	Price
ILI-0001.ME	Mortise Entry	\$380
ILI-0001.PA	Mortise Passage	\$286
ILI-0001.PR	Mortise Privacy	\$313
ILI-0001.FD	Full Dummy	\$211

### Vienna Mortise

Plate: 2-1/8" X 10-1/8"

Lever: 5-1/8"



Item	Description	Price
ILI-0002.ME	Mortise Entry	\$348
ILI-0002.PA	Mortise Passage	\$254
ILI-0002.PR	Mortise Privacy	\$281
ILI-0002.FD	Full Dummy	\$179

### Black Forest Mortise

Plate: 2-3/8" X 10-1/4"

Lever: 5"



Item	Description	Price
ILI-0003.ME	Mortise Entry	\$304
ILI-0003.PA	Mortise Passage	\$210
ILI-0003.PR	Mortise Privacy	\$237
ILI-0003.FD	Full Dummy	\$135

### Salzburg Mortise

Plate: 2-1/8" X 9-1/2"

Lever: 5-1/8"



Item	Description	Price
ILI-0006.ME	Mortise Entry	\$327
ILI-0006.PA	Mortise Passage	\$233
ILI-0006.PR	Mortise Privacy	\$260
ILI-0006.FD	Full Dummy	\$158

### Salzburg Imperial Mortise

Plate: 2-3/8" X 10-1/4"

Lever: 6-1/8"



Item	Description	Price
ILI-0007.ME	Mortise Entry	\$384
ILI-0007.PA	Mortise Passage	\$290
ILI-0007.PR	Mortise Privacy	\$317
ILI-0007.FD	Full Dummy	\$215

### Vienna Imperial Mortise

Plate: 2-7/8" X 11-1/8"

Lever: 5-1/8"



Item	Description	Price
ILI-0008.ME	Mortise Entry	\$347
ILI-0008.PA	Mortise Passage	\$253
ILI-0008.PR	Mortise Privacy	\$280
ILI-0006.FD	Full Dummy	\$178

### Tirol Mortise (Iron Pewter Finish)

Plate: 1-3/4" X 9"

Lever: 4-1/2"





Item	Description	Price
ILI-0004.ME	Mortise Entry	\$355
ILI-0004.PA	Mortise Passage	\$261
ILI-0004.PR	Mortise Privacy	\$288
ILI-0004.FD	Full Dummy	\$186

### Provencal Mortise

Plate: 2-1/16" X 9-7/8"

Lever: 5-1/2"



Item	Description	Price
ILI-0005.ME	Mortise Entry	\$353
ILI-0005.PA	Mortise Passage	\$259
ILI-0005.PR	Mortise Privacy	\$286
ILI-0005.FD	Full Dummy	\$184

### Mozart Mortise

Plate: 2-1/16" X 9-7/8"

Lever: 5"



Item	Description	Price
ILI-0026.ME	Mortise Entry	\$355
ILI-0026.PA	Mortise Passage	\$261
ILI-0026.PR	Mortise Privacy	\$288
ILI-0026.FD	Full Dummy	\$186

### Tirol Imperial Mortise

Plate: 2" X 10-1/2"

Lever: 5-1/2"



Item	Description	Price
ILI-0027.ME	Mortise Entry	\$490
ILI-0027.PA	Mortise Passage	\$490
ILI-0027.PR	Mortise Privacy	\$490
ILI-0027.FD	Full Dummy*	\$200

\*Plain Inside & Outside Plates (No Turn Knob, No Cylinder)

### Alpine Mortise

Plate: 2-1/16" X 9-7/8"

Lever: 5"



Item	Description	Price
ILI-0015.S	Single Deadbolt	\$462
ILI-0015.D	Double Deadbolt	\$483

### Vienna Imperial Deadbolt Entry

Plate: 2-7/8" X 11-1/8"

Lever: 5-1/8"



Item	Description	Price
ILI-0016.S	Single Deadbolt	\$398
ILI-0016.D	Double Deadbolt	\$419

### Salzburg Imperial Deadbolt Entry

Plate: 2-3/8" X 10-1/4"

Lever: 6-1/8"



### **Danube Multi-Point Entry**

Plate: 2" X 9-5/8"

Lever: 4-34"



### **Strauss Multi-Point Entry**

Plate: 2" X 9-5/8"

Lever: 4-34"

Item	Description	Price
ILI-0030.MPA	Active Leaf	\$464
ILI-0030.MPI	Inactive Leaf	\$464
ILI-0030.ME.92	Mortise Entry (92mm Centers)	\$
ILI-0030.ME.72	Mortise Entry (72mm Centers)	\$354
ILI-0030.FD	Full Dummy	\$197

Item	Description	Price
ILI-0029.MPA	Active Leaf	\$415
ILI-0029.MPI	Inactive Leaf	\$415
ILI-0029.ME.92	Mortise Entry (92mm Centers)	\$
ILI-0029.ME.72	Mortise Entry (72mm Centers)	\$304
ILI-0029.FD	Full Dummy	\$152





**Vienna Lever/Rosette**  
**Rosette 2-1/2" Lever 5-1/8"**

Item	Description	Price
ILI-0009.PA	Passage	\$268
ILI-0009.PV	Privacy	\$270
ILI-0009.FD	Full Dummy	\$190

**Innsbruck Lever/Rosette**  
**Rosette 2-1/2" Lever 4-3/4"**

Item	Description	Price
ILI-0010.PA	Passage	\$266
ILI-0010.PV	Privacy	\$270
ILI-0010.FD	Full Dummy	\$190

**Salzburg Lever/Rosette**  
**Rosette 2-7/8" Lever 5-1/8"**

Item	Description	Price
ILI-0011.PA	Passage	\$199
ILI-0011.PV	Privacy	\$202
ILI-0011.FD	Full Dummy	\$122



**Black Forest Lever/Rosette  
Rosette 2-1/2" Lever 4-3/4"**

Item	Description	Price
ILI-0012.PA	Passage	\$264
ILI-0012.PV	Privacy	\$267
ILI-0012.FD	Full Dummy	\$188

**Alpine Lever/Rosette  
Rosette 2-1/2" Lever 5-1/8"**

Item	Description	Price
ILI-0013.PA	Passage	\$199
ILI-0013.PV	Privacy	\$202
ILI-0013.FD	Full Dummy	\$122

**Mozart Lever/Rosette  
Rosette 2-7/8" Lever 5-1/2"**

Item	Description	Price
ILI-0014.PA	Passage	\$240
ILI-0014.PV	Privacy	\$244
ILI-0014.FD	Full Dummy	\$163

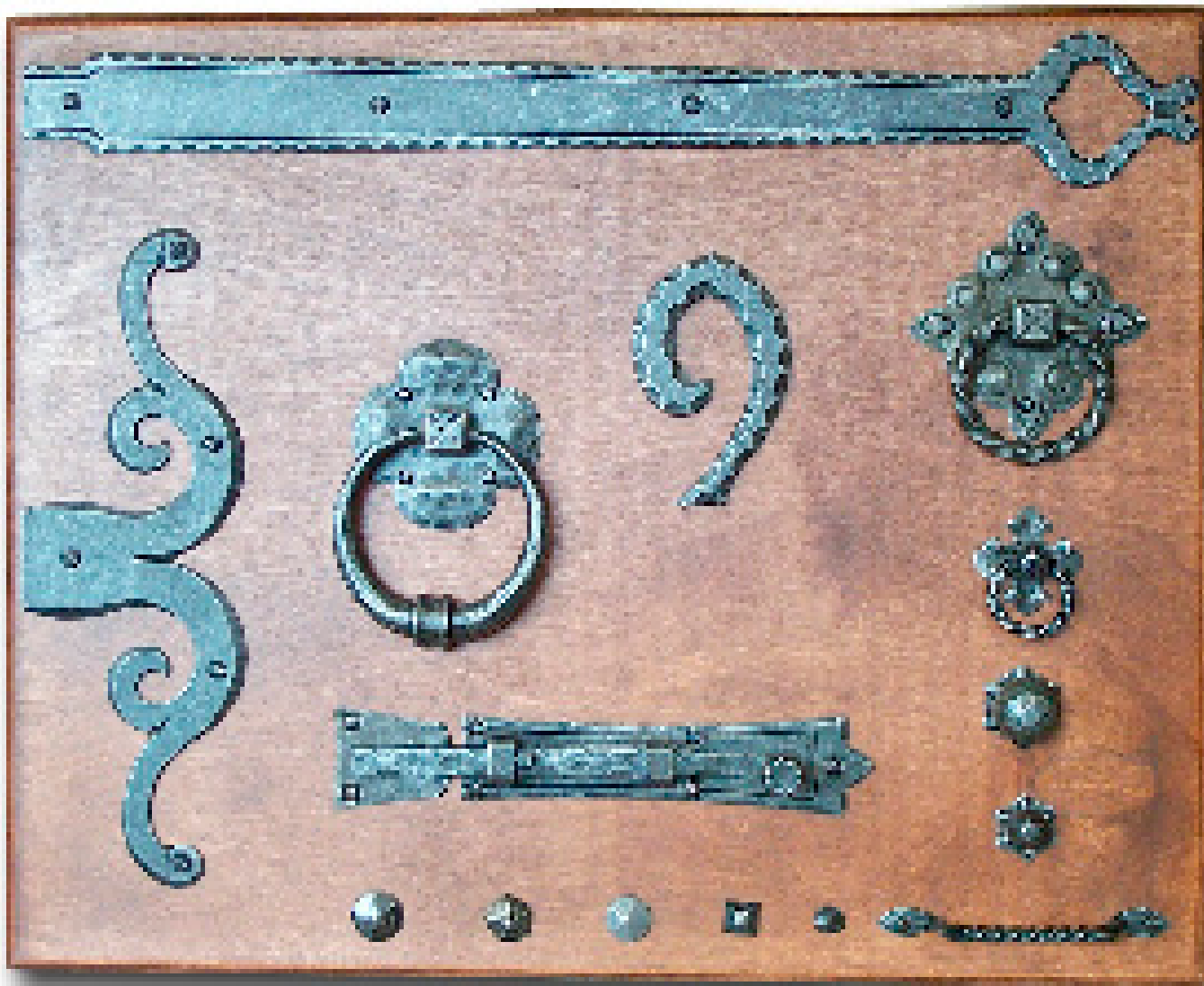

### Door and Cabinet Accessories

Item ID	Description	Size	Price
ILI-0019.L	Long Strap	2" X 23-5/8"	\$81
ILI-0019.S	Short Strap	4-5/16" X 12-5/8"	\$73
ILI-0021	Knocker	4" Ring Dia.	\$83
ILI-0023	House Number 0 - 9	3-1/2" X 5-1/8"	\$20
ILI-0027	Armoire/Closet Pull	4" Ring Dia.	\$68
ILI-0026	Drop Ring Cab. Pull	2" X 2-1/2"	\$13
ILI-0024.5	Hammered Cab. Pull	1/2" Dia.	\$13
ILI-0024.1	Hammered Cab. Pull	1" Dia.	\$13
ILI-0022.08	Surface Bolt	8" Length	\$121
ILI-0022.12	Surface Bolt	12" Length	\$130
ILI-0028.1B	Hammered Door Nail	1" Dia. Black	\$2
ILI-0028.75B	Hammered Door Nail	3/4" Dia. Black	\$2
ILI-0028.75P	Hammered Door Nail	3/4" Dia. Iron Pewter	\$2
ILI-0028.58B	Hammered Door Nail	5/8" Square Black	\$2
ILI-0028.5B	Hammered Door Nail	1/2" Round Black	\$2
ILI-0025	Cabinet Twist Pull	4-5/8" Length	\$13

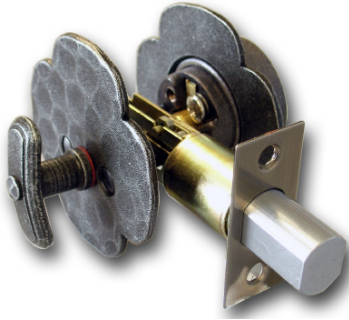

**DEAD BOLT**  
**Typical Exploded Assem-**  
**bly View Adjustable Back**  
**Set: 2-3/8" - 2-3/4"**

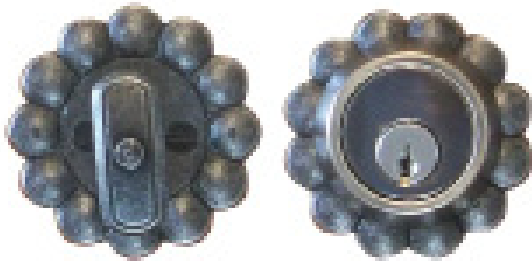
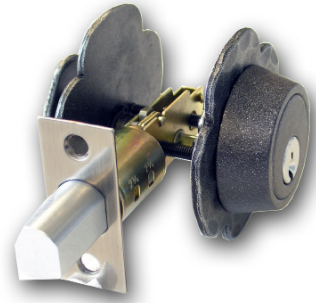

**Vienna/Black Forest**  
**Single Dead Bolt**

ILI-0017.VBS

\$164

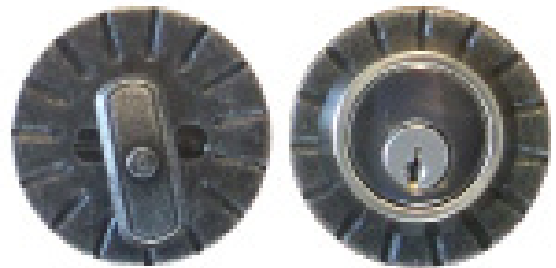

**Alpine/Innsbruck**  
**Single Dead Bolt**

ILI-0017.AIS

\$164

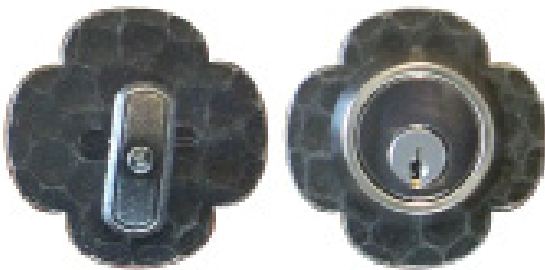

**Salzburg/Mozart**  
**Single Dead Bolt**

ILI-0017.SMS

\$164



**Vienna/Black Forest**  
**Double Dead Bolt**

ILI-0017.VBD

\$185

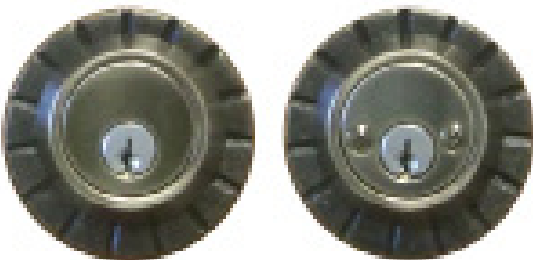

**Alpine/Innsbruck**  
**Double Dead Bolt**

ILI-0017.AID

\$185



**Salzburg/Mozart**  
**Double Dead Bolt**

ILI-0017.SMD

\$185



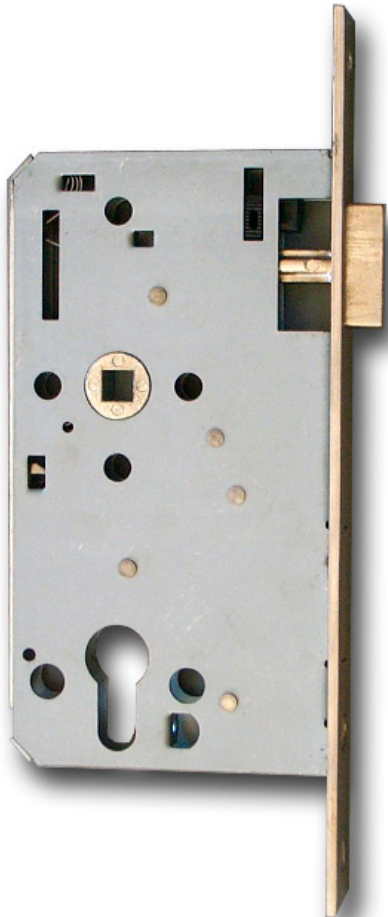

### **ILI 115-PZW Mortise Entry**

Finish: Stainless Steel Face Plate

Reversible

2-7/8" (72mm) Lever-to-Cylinder Centers

Face Plate: 1-1/16" X 9-3/16" (24mm X 234mm)

Profile Cylinder Required: YES

2-3/8" (60mm Back Set) SS **\$110**

Passage **\$90**

### **WILKA 5590-PZW Mortise Entry**

Finish: Stainless Steel or Polished Brass Face Plate

Reversible

2-7/8" (72mm) Lever-to-Cylinder Centers

Face Plate: 1-1/16" X 9-3/16" (24mm X 234mm)

Profile Cylinder Required: YES

2-3/8" (60mm Back Set) SS **\$124**

2-3/8" (60mm Back Set) PB **\$140**

2-3/4" (70mm Back Set) **NA**

### **WILKA 5591-F PZ Passage**

Finish: Stainless Steel Face Plate

Reversible

2-7/8" (72mm) Lever-to-Cylinder Centers

Face Plate: 1-1/16" X 9-3/16" (24mm X 234mm)

Profile Cylinder Required: No

2-3/8" (60mm Back Set) SS **\$124**

2-3/4" (70mm Back Set) **NA**

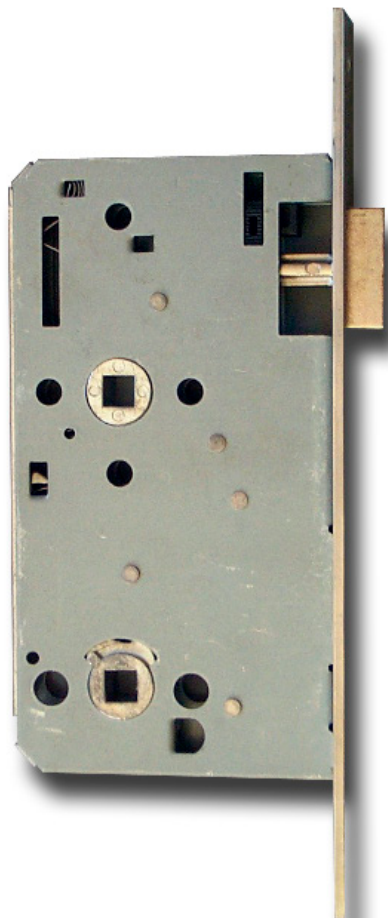

### **KFY 115-WC Privacy Mortise DISCONTINUED**

Finish: Stainless Steel Face Plate

Reversible

3-1/16" (78mm) Lever-to-Bolt-Hub Centers

Face Plate: 15/16" X 9-3/16" (24mm X 234mm)

Profile Cylinder Required: NO

2-3/8" (60mm Back Set) SS **NA**

2-3/4" (70mm Back Set) SS **N/A**

### **KFY 113-WC Privacy Mortise**

Finish: Stainless Steel Face Plate

**Non-Reversible** - Ships Left or Right Hand

3-1/16" (78mm) Lever-to-Bolt-Hub Centers

Face Plate: 15/16" X 9-3/16" (24mm X 234mm)

Profile Cylinder Required: NO

2-3/8" (60mm Back Set) SS **\$117**

2-3/4" (70mm Back Set) **N/A**

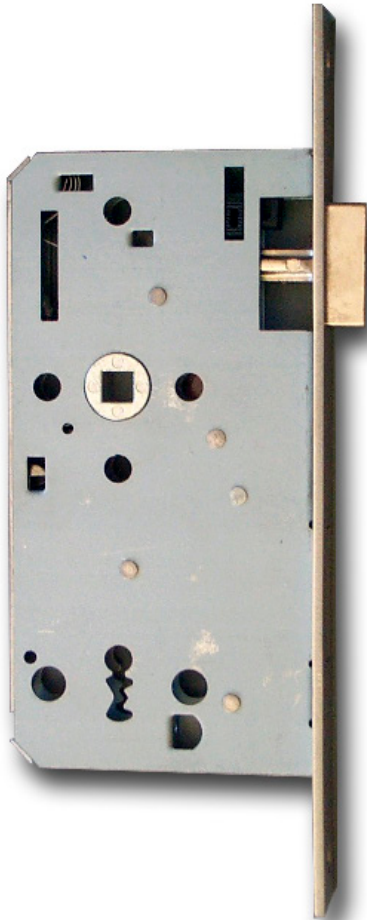

### **KFV 115-BB Bit-Key Mortise**

Finish: Stainless Steel Face Plate

Reversible

2-7/8" (72mm) Lever-to-Key Centers

Face Plate: 15/16" X 9-3/16" (24mm X 234mm)

Profile Cylinder Required:NO

2-1/8" (55mm Back Set) SS **\$130**

2-3/4" (70mm Back Set) N/A



### **KFV 521-PZW Narrow Backset Mortise Entry**

**DISCONTINUED**

Finish: Stainless Steel Face Plate

Non-Reversible Ships Left or Right Hand

2-7/8" (72mm) Lever-to-Cylinder Centers

Face Plate: 15/16" X 9-3/16" (24mm X 234mm)

Profile Cylinder Required: YES

1-9/16" (40mm Back Set) SS **NA**



### **KFV 1133-PZW Heavy Duty Mortise Entry**

Finish: Stainless Steel Face Plate

Handed: L/R

2-7/8" (72mm) Lever-to-Cylinder Centers

Face Plate: 15/16" X 9-3/16" (24mm X 234mm)

Profile Cylinder Required: YES

2-3/8" (60mm Back Set) SS **\$174**

2-3/4" (70mm Back Set) SS **\$210**



### **KFV 154-PZW Mortise Entry **DISCONTINUED****

Finish: Stainless Steel Face Plate

Non-Reversible Ships Left or Right Hand

2-7/8" (92mm) Lever-to-Cylinder Centers

Face Plate: 15/16" X 11" (24mm X 280mm)

Profile Cylinder Required: YES

2-3/8" (60mm Back Set) SS **N/A**

2-3/4" (70mm Back Set) **N/A**



### **ILI 115.85-PZW Narrow Backset Mortise Entry**

Finish: Stainless Steel, Bronze Face Plate

Reversible

3.35" (85mm) Lever-to-Cylinder Centers

Face Plate: 15/16" X 9-3/16" (24mm X 234mm)

Profile Cylinder Required: YES

2" (50mm Back Set) SS BR **\$75**

### **Profile Cylinders**



**ILI - 60mm**

**Up to 1-3/4" Thick Doors**

**\$85**



**ILI - 80mm**

**Up to 2" Thick Doors**

**\$101**



**ILI - 100mm**

**Up to 3" Thick Doors**

**\$154**



## Latch Bolts



ILI-0238.PA Passage Latch: **\$80**

ILI-0238.PV Privacy Latch: **\$81**

Drill Size: 1"

O. A. Length: 3-1/2" Face Plate to Back End

Back Set: 2-3/8" Door Edge to Lever Hub Center

Face Plate: 1" X 2-1/4"



ILI-0275.PA Passage Latch: **\$88**

ILI-0275.PV Privacy Latch: **\$90**

Drill Size: 1"

O. A. Length: 4" Face Plate to Back End

Back Set: 2-3/4" Door Edge to Lever Hub Center

Face Plate: 1" X 2-1/4"

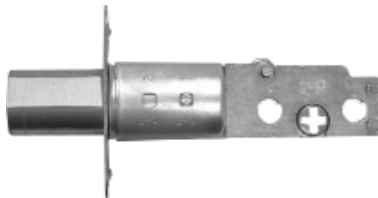

ILI-0238/0275.DBL Dead Bolt Latch: **\$67**

Adjustable: 2-3/8" or 2-3/4" Back Set

Drill Size: 1"

O. A. Length: 3-1/8" or 3-1/4" Face Plate to Back End

Face Plate: 1" X 2-1/4"

## Spindles



8mm (5/16") Sq. X 100mm (4") **\$10**

Offset End Hole for M5 Punch-Thru Set Screw



8mm (5/16") Sq. X 130mm (5-1/8") **\$12**

Offset End Hole for M5 Punch-Thru Set Screw



8mm (5/16") Sq. X 30mm (1-3/16") **\$14**

Dummy Half Spindle

Offset End Hole for M5 Punch-Thru Set Screw



8mm (5/16") Sq. X 112mm (4-1/2") **\$12**

Grooved Swivel Spindle

Privacy Latches and Other Split-Hub Latches



8mm (5/16") Sq. X 125mm (5") **\$14**

Grooved Swivel Spindle

Privacy Latches and other Split-Hub Latches



8mm (5/16") Sq. X 95mm (3-1/2") **\$10**

Grooved and Slotted Threaded Swivel Spindle

Privacy Latches and other Split-Hub Latches

## **Terms of Sale**

### **Payment**

**Payments by credit card through PayPal or by Bank wire transfer.**

### **Returns**

**Products to be returned to the factory, regardless of reason, must be factory authorized and have a factory assigned Returned Goods Authorization on the outside of the box in which the products are returned. Packages returned without factory authorization will be refused and returned to the sender at sender's expense. Product authorized for return to the factory within 10 working days of receipt of goods is fully refunded provided the merchandise is returned unopened and unused condition with all screws, parts and original packaging intact. All other returns will be subject to a 25% restock fee except defective merchandise in which case our Limited Lifetime Warranty applies.**

### **Technical Support**

**Our mortise locks are provided with installation templates. Your installer must have a mortise lock installation tool which includes a router and bit capable of making at least a 4" deep X 5/8" wide vertical slot in the edge of a solid wood door. Please do not hesitate to contact us at the toll-free number below with any questions regarding the proper installation of our products or if you need to purchase installation tools.**

### **Limited Lifetime Warranty**

**Iron Lock Imports, at its option, will repair or replace any lock, lock trim, lock function or accessory supplied by us which fails to operate as a result of a manufacturing defect within 5 years of original purchase of material by the original owner. This warranty excludes damage from abuse, improper installation, attack or attempted forced entry.**

**TOLL FREE NO. 877-650-5101**

**06/01/2018**